

CM-RQE70A Series PIR 'Request to Exit' Detectors



UL 294 and ULC-S319
Standards for Access Control



Camden's CM-RQE70A Series PIR 'Request To Exit' Detectors provide the latest "high performance" features, including secondary activation device input, door monitoring, two relay outputs, tamper alarm, and more. The compact size allows the CM-RQE70A to easily fit on door frames, while installation is easy and fast.

Have an unusual installation and need custom settings? No problem, you can use the on-board push buttons to customize the default operating modes or program your own custom operating mode. CM-RQE70A isn't just a new REX detector, it's a whole new approach to REX detector design!

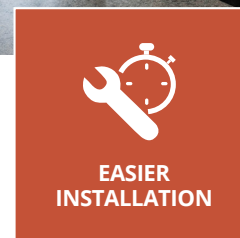
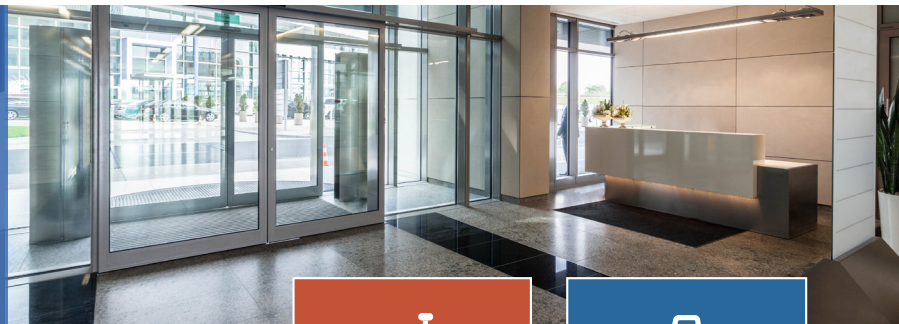

EASIER
INSTALLATION

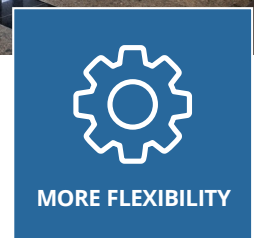

MORE FLEXIBILITY

Features

- Compact size, designed to mount on door frames
- Easy to use on-board programming buttons. No dip switches
- (4) Factory default operating modes, with the ability to customize mode attributes
- Selectable fail safe/fail secure
- (2) Form 'C' contacts
- Momentary and latching relay modes
- Secondary activation device input
- Card/keypad Input
- Door position switch input
- Request to exit input
- Built-in sounder (adjustable)
- Tamper switch



SPECIFICATIONS

VOLTAGE:	12/24 VDC operation	PIEZO BUZZER:	92dB @ 10cm
CURRENT DRAW:	50mA (max)	INDICATOR:	Activation LED
RELAYS:	(2) Form 'C' (DPDT)	CARD OR KEYPAD INPUT:	(1) N/O
CONTACT RATING:	3A @ 30 VDC	DOOR POSITION SWITCH INPUT:	(1) N/O
PROGRAMMING:	On-board push buttons and status LED	REQUEST TO EXIT INPUT:	(1) N/O
MODES:	(4) Factory Default, (1) Fully Custom, Selectable Fail Safe/Fail Secure	TAMPER SWITCH CONTACT RATING:	50mA @ 12 VDC
COVERAGE:	- Max. 10' W x 10' H - Horizontal & vertical adjustment (mechanical) - Sensor sensitivity/range (electronic)	TEMP OPERATING RANGE:	32°F-120°F (0-50°C)
TIME DELAY:	Adjustable, 5, 15, 30, 45 & 60 second	HUMIDITY RANGE:	0-93% non condensing
DIMENSIONS:	1-3/4"H x 7"W x 1-3/4"D (43mm x 176mm x 43mm) Adaptor Plate: 2"H x 3"W x 8"L (51mm x 76mm x 203mm)	WEIGHT:	0.25 lbs (0.12kg)
		COLORS:	White or black models
		SOUNDER:	On/off, with adjustable volume

ORDERING INFORMATION

CM-RQE70A	PIR 'Request to Exit' detector, white, w/ wiring terminal, 12/24 VDC
CM-RQE70ABK	PIR 'Request to Exit' detector, black, w/ wiring terminal, 12/24 VDC
CM-RQEPW	Single gang adaptor plate (white)
CM-RQEPK	Single gang adaptor plate (black)

CM-RQE70A WITH ADAPTOR PLATE

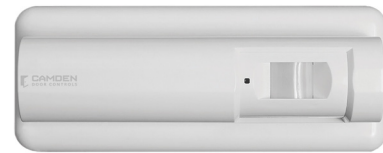

SPECIAL OPERATING MODES

Camden CM-RQE70A Series REX detectors offer (4) factory default operating modes, selected by programming buttons on the circuit board

MODE 1	Latched REX Sensor: Relay activated, held by timer
MODE 2	Door Prop Alarm: Detector will alarm if held open
MODE 3	Access Control: Detector controlled by system or secure device
MODE 4	Secondary Activation Mode: The sensor requires activation of Input #3 before activating the output relay
MODE 5	Custom Settings

DIMENSIONS

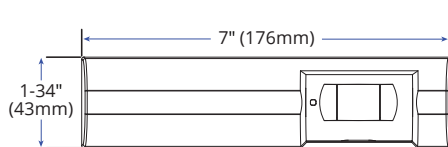

Front View

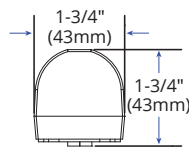

Side View

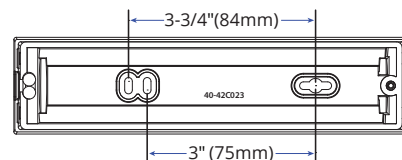

Back View



Opening New Doors to Innovation, Quality, and Support!

2395 Skymark Ave, Mississauga, ON Canada L4W 4Y6 • Toll Free: 1(877) 226-3369 (CAMDEN9)
Tel: (905) 366-3377 | Fax: (905) 366-3378 | E-mail: info@camdencontrols.com | www.camdencontrols.com



Part #: MKTG-LIT-SP-CM-RQE70