

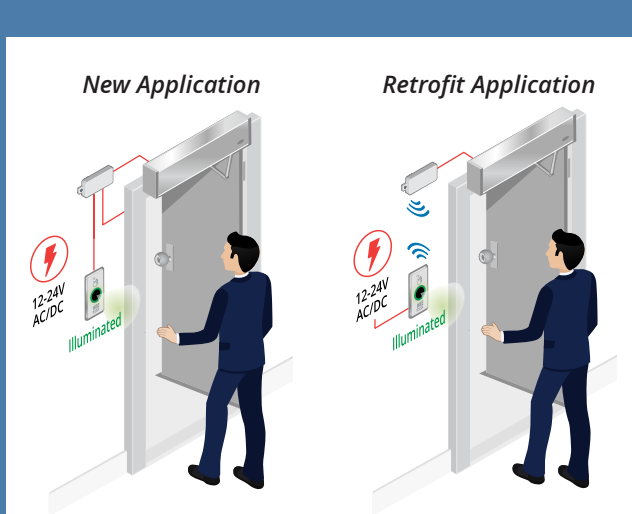

Model Selection Guide



CM-331 1 Relay

Includes option for Light Ring and Wireless Transmitter

New Application

Ideal for activation and control, where door status indication is required. This eliminates the need for a separate door control relay.

Retrofit Application

Ideal for replacement of non-powered switches, without battery maintenance. Re-use 2 existing wires for power and optional CM-TX99 plug-in wireless transmitter to activate door opening.



LINE
POWERED



1
RELAY



LIGHT RING
OPTION



BUILT-IN
CONTROL



WIRELESS
OPTION

CM-332 2 Relays, Line Powered

Includes option for Light Ring and Wireless Transmitter

Ideal for activation and control of two doors, particularly vestibule applications. This eliminates the need for a separate door control relay.



LINE
POWERED



2
RELAYS



LIGHT RING
OPTION



BUILT-IN
CONTROL



WIRELESS
OPTION

CM-333 1 Relay, Hybrid Battery Powered

Designed to retrofit non-powered push plate switches with sensor switches without any additional wiring.

These switches offer the longest alkaline battery life of any switch in the market, with the option for lithium batteries.



BATTERY
POWERED



1
RELAY





CM-336 *Battery Powered*

Ideal for door activation where installing wiring is difficult or expensive, and for instant replacement of non-powered switches in retrofit applications.

These switches offer the longest alkaline battery life of any switch in the market, with the option for lithium batteries. CM-RX90 receiver required.



BATTERY
POWERED



LAZERPOINT RF™
WIRELESS



CM-324 *1 Relay, Line Powered*

Ideal for economical door activation where a door or locked status indicator is not required.

These switches feature an operating range of 1"-30" and an adjustable time delay of 1-5 seconds, providing superior performance in ambient lighting conditions.



LINE
POWERED



1
RELAY



CM-325 *1 Relay, Short Range*

Ideal for short range sensing in confined areas such as in restrooms.

These switches are designed for use in healthcare and facilities where highly reflective surfaces (chrome or polished stainless steel) cause standard switches to false activate.



LINE
POWERED



1
RELAY



SHORT RANGE
MODEL



Opening New Doors to
Innovation, Quality and Support!



For a complete list of all SureWave™ Touchless
Switch Kits, please visit camdencontrols.com

